

**TREE PRESERVATION NOTES**

- All conditions necessitating the removal or pruning of a tree shall be reviewed by Landscape Architect. The locations of any improvements with the potential of impacting trees shall be staked/delineated prior to the field review.
- Root Protection Zone (RPZ): RPZ requirements are defined as 12" diameter per 1" caliper of trunk at 42" height (Diameter Breast Height, DBH). Minimum RPZ requirements are 6' to each 1" caliper at DBH or 5' to trunk whichever is greater.
- Barricade fencing shall be placed to protect RPZ of all trees to remain that are adjacent to construction or disturbed areas unless otherwise approved by Landscape Architect to provide access to work. In these instances the minimum distance for barricade fencing from trunk shall be equal to 50% minimum of RPZ. Five foot (5'-0") from trunk of tree or clump of trees is allowed on one side of the tree with approved alternative construction methods only. Full RPZ is required on other side. Approval from City Arborist/Tree Inspector is required.
- No equipment, vehicles or materials shall be operated or stored within the root protection zone. No clean-out areas will be constructed so that the material will be in or migrate to the root protection zone.
- Roots or branches in conflict with construction shall be cut cleanly according to proper pruning methods. All Oak wounds shall be painted within 30 minutes to prevent Oak Wilt Infection.
- Exposed roots shall be covered at the end of the work day using techniques such as covering with soil, mulch or wet burlap.
- All woody material to be removed may be chipped into mulch & distributed on site within RPZ's at trees adjacent to construction & natural areas.
- Trees which are damaged or lost due to contractor's negligence during construction shall be mitigated.
- In addition, existing protected trees on a project are to be maintained in a healthy condition at all times. This includes watering, fertilizing, pruning and other maintenance as needed on the project. Trees that die within 12 months shall be replaced per the City's Unified Development Code.

**TREE PRESERVATION ORDINANCE**

TREE NUMBER	DIAMETER BREAST HEIGHT	SPECIES	SIZE CLASS	HERITAGE TREES		LARGE TREES		MEDIUM TREES		SMALL TREES		TREE CREDIT	
				TO REMAIN	TO BE REMOVED	TO REMAIN	TO BE REMOVED	TO REMAIN	TO BE REMOVED	TO REMAIN	TO BE REMOVED		
001	8"	Hackberry	Medium									outside of project limits	
002	8"	Hackberry	Medium									outside of project limits	
003	8"	Hackberry	Medium									outside of project limits	
004	8"	Hackberry	Medium									outside of project limits	
005	8"	Hackberry	Medium									outside of project limits	
006	8"	Hackberry	Medium									outside of project limits	
007	8"	Hackberry	Medium									outside of project limits	
008	8"	Hackberry	Medium									outside of project limits	
009	8"	Hackberry	Medium									outside of project limits	
010	8"	Hackberry	Medium									outside of project limits	
011	8"	Hackberry	Medium									outside of project limits	
012	8"	Hackberry	Medium									outside of project limits	
013	8"	Hackberry	Medium									outside of project limits	
014	8"	Hackberry	Medium									outside of project limits	
015	8"	Hackberry	Medium									count as 3 trees	
016	8"	Hackberry	Medium									count as 3 trees	
017	8"	Hackberry	Medium									count as 3 trees	
018	8"	Hackberry	Medium									count as 3 trees	
019	8"	Hackberry	Medium									count as 3 trees	
020	8"	Hackberry	Medium									count as 3 trees	
021	8"	Hackberry	Medium									count as 3 trees	
022	8"	Hackberry	Medium									count as 3 trees	
023	8"	Hackberry	Medium									count as 3 trees	
024	8"	Hackberry	Medium									count as 3 trees	
025	8"	Hackberry	Medium									count as 3 trees	
026	8"	Hackberry	Medium									count as 3 trees	
027	24	Hackberry	Heritage	x								count as 4 trees	
028	18	Hackberry	Large			x						count as 4 trees	
029	24	Hackberry	Medium									count as 4 trees	
030	6"	Hackberry	Small									x	
031	6"	Hackberry	Small									x	
032	16	Hackberry	Large				x					x	
033	6"	Hackberry	Small									x	
034	24	Hackberry	Heritage		x								
035	8"	Hackberry	Medium										
TOTAL TREES ON-SITE (within Artificial Lot Line)												1	23
TOTAL TREES PRESERVED													14
TOTAL TREES REMOVED													9
TOTAL PRESERVATION													61.00%

**LANDSCAPE ORDINANCE**

TOTAL STREET YARD: 9956 sf  
 TREES REQUIRED IN STREET YARD  
 One tree per each 1500 sf of the first 9,000 sf of streetyard area: 6 trees  
 One tree per 3,000 sf of streetyard area between 9,000 to 90,000 sf: 1 trees

Total streetyard tree planting required: 7 trees  
 Total streetyard tree planting (Tree Credit) shown: 44 Trees

PARKING LOT TREE PLANTING  
 TOTAL PARKING SPACES: 14 SPACES  
 Required parking islands (1 island per 12 parking spaces (14 spaces/12 spaces): 6 areas  
 Parking islands /green space shown: 6 areas  
 Required parking lot trees (1 per island and green space): 6 trees  
 Parking lot trees shown (4 existing trees and 2 proposed trees): 6 trees

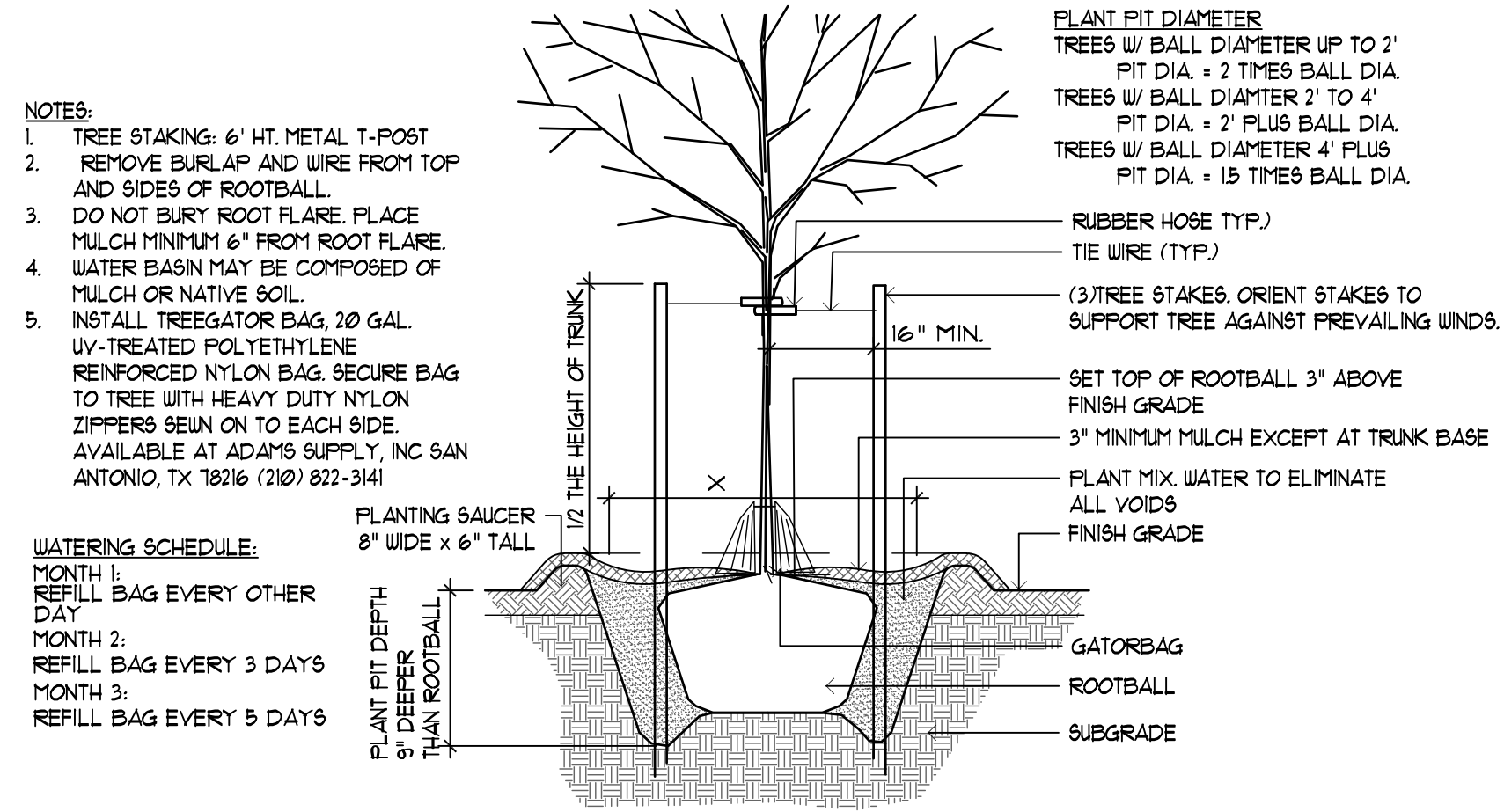

**TREE PLANTING**  
Not to Scale

**Exhibit B**

**PLANTING NOTES:**

- The landscape contractor is to notify Texas One Call (811 or 800-545-6005) 72 hours prior to any excavation. Landscape contractor shall be responsible for making himself familiar with all underground utilities, pipes and structures. Landscape contractor shall take sole responsibility for any cost incurred due to damage of said utilities whether or not Texas One Call is notified.
- Do not willingly proceed with construction as designed when it is obvious that unknown obstruction and/or grade differences exist that may not have been known during design. Such conditions shall be immediately brought to the attention of the Landscape Architect. The Contractor shall assume full responsibility for all necessary revisions due to failure to give such notification.
- The Contractor shall be responsible for any coordination with subcontractors as required to accomplish planting operations.
- If conflicts arise between size of areas and plans, Contractor is to contact Landscape Architect for resolution. Failure to make such conflicts known will result in Contractor's liability to relocate the materials.
- Unless otherwise noted, all disturbed areas to receive hydro-seed with common Bermuda seed.
- Soccer field shall receive sod to match existing soccer field.
- All proposed trees shall receive 4" of double shredded hardwood mulch.

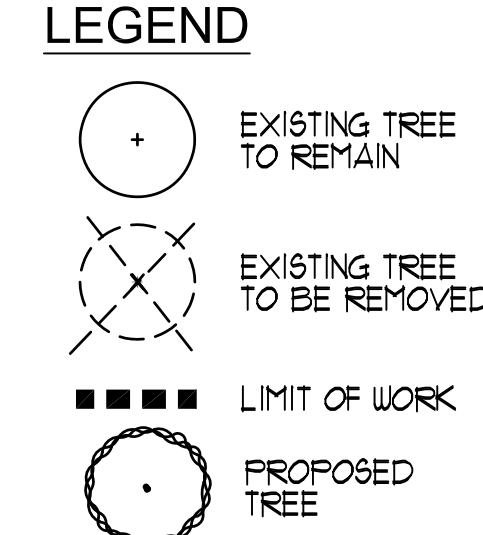
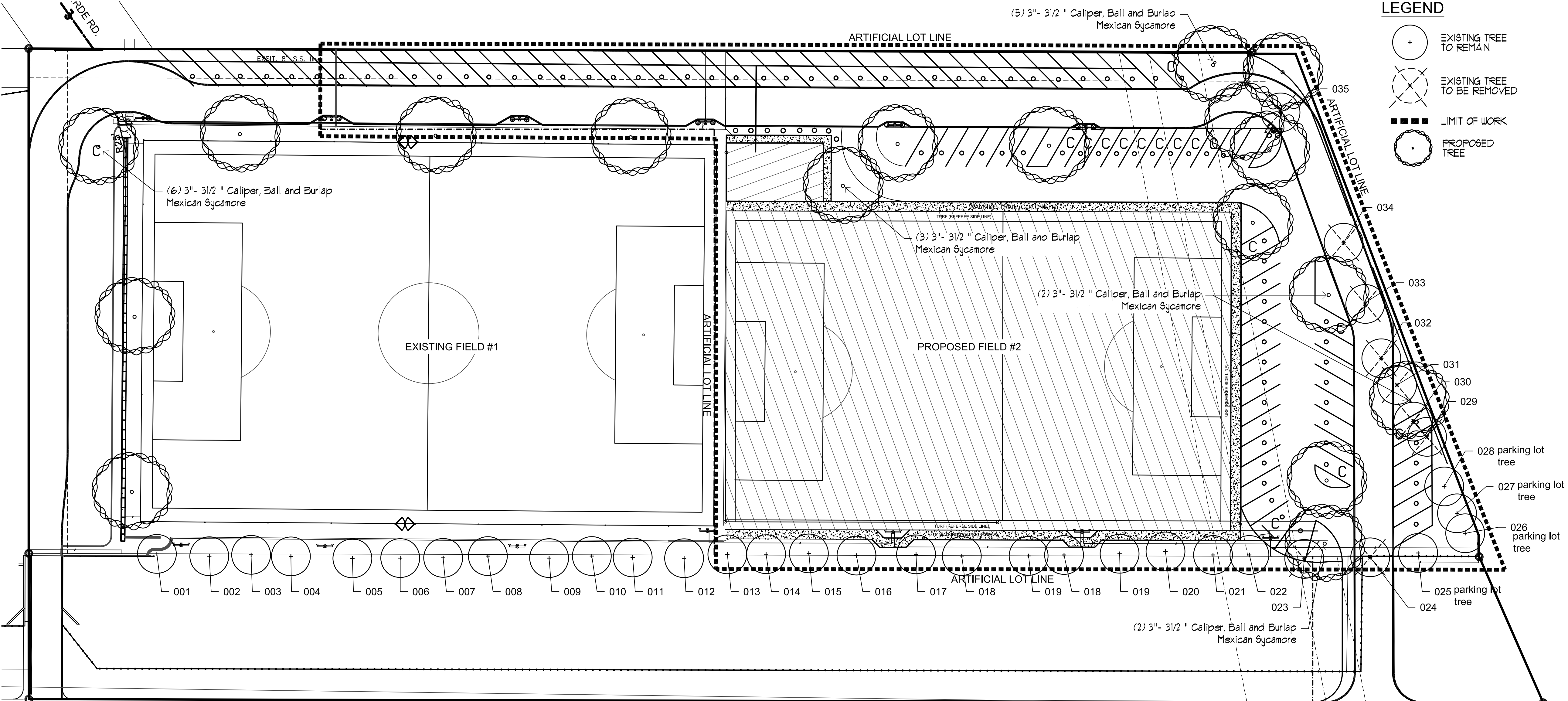

**VICKREY & ASSOCIATES, INC.**  
 CONSULTING ENGINEERS  
 CIVIL - LANDSCAPE ARCHITECTURE - SURVEY  
 12940 Country Parkway, Suite 200, Houston, TX 77040  
 Phone: 281.480.9200  
 Fax: 281.480.9202  
 EIR Registration No: F-159  
 TBPLS Firm Registration No: 10004100

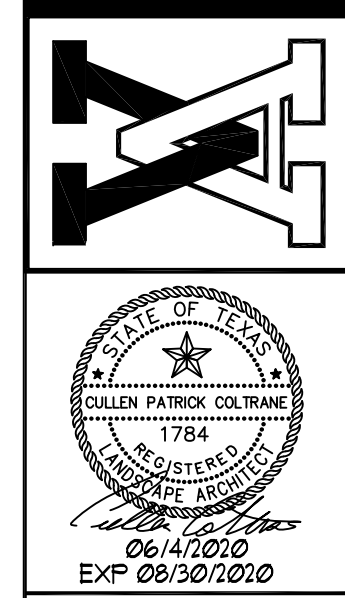

**OLYMPUS SOCCER COMPLEX  
 PHASE 2  
 TREE PRESERVATION AND LANDSCAPE  
 PLAN  
 LEON VALLEY, BEXAR COUNTY, TEXAS**

DATE: January 2020  
 Vertical Scale: 1"=1'-0"  
 Horizontal Scale: 1"=30'-0"  
 SHEET 1 OF 1  
 PROJ NO. 2788-001

Jun 04, 2020 - 9:56am  
 R:\2788-001\landscape\2788001\_landscape.dwg

DRAWN BY: SDT CHECKED BY: CC APPROVED BY: CC

**1 TREE PRESERVATION PLAN**  
 SCALE: 1"=30'-0"  
 NORTH

SHADOW MIST